

**SYSTEM
PLAST**

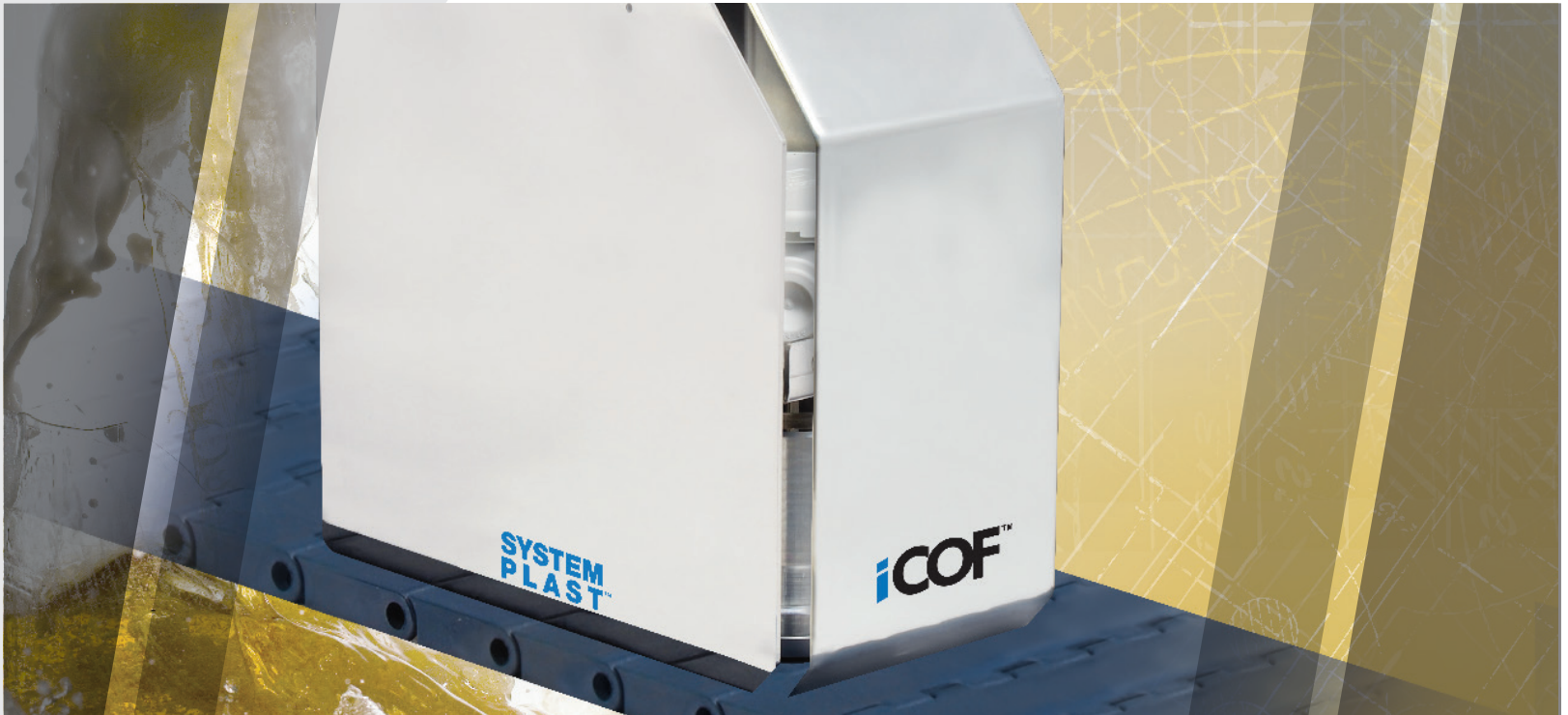

CONDITION MONITORING

iCOF™

RegalRexnord™

ICOF - COMPLETE UNIT

SLIDERS INCLUDED



Item description: ICOF-PET
Item number: AA1313628

Application type: PET



Item description: ICOF-CAN
Item number: AA1313629

Application type: CAN



Item description: ICOF-GLASS
Item number: AA1313630

Application type: GLASS



WHY COEFFICIENT OF FRICTION?

Variations in the coefficient of friction are a good indicator of changing conditions or pollution of the conveyor. Especially in dry running lines, the friction is a key factor for the proper handling and flow of containers. A permanent control process will help maintain the optimum conditions and thus guarantee the line efficiency.

HOW DOES IT WORK?

The iCOF® condition monitoring device can be mounted on a conveyor and integrated in the line control system. It measures the friction at regular intervals that can be set by the user. Obtained data is used to calculate the average value as well as the standard deviation and the trend. The values can trigger a signal once a pre-set limit is passed. Based on this signal, the user can check the situation and decide about the required corrective action. Output is done through ethernet or Modbus connections. Obviously for integration in the line control system, a close cooperation with the OEM is required. The iCOF device can also be used as a stand-alone or portable device for spot measurements.

WHERE CAN IT BE USED?

The iCOF device can be used throughout the line wherever it makes sense to temporarily or continuously monitor the friction to collect performance data, obtain data for trouble shooting or to act as continuous input for the line controls.

FEATURES:

- Real time monitoring of the line condition
- Addressing all container type (PET, glass and cans)
- The iCOF condition device continuously measures the coefficient of friction
- The iCOF condition device calculates average value, standard deviation and a trend
- The iCOF condition device triggers an alarm if pre-set limits are reached
- The iCOF condition device can be portable or integrated in line control system

BENEFITS:

- No operator intervention required for measuring
- Easy to define optimum cleaning regime: "Smart Cleaning"
- Corrective action can be scheduled before efficiency is affected
- Long term line condition can be analyzed using data from the iCOF device



WHAT IS THE CONDITION MONITORING DEVICE

The iCOF condition monitoring device continuously measures the condition of a bottle or can independently from the conveyor.

Beverage plants have less resources and maintain the conveyors. Continuous monitoring can be a great help to make the desired

ICOF SPARE PARTS - SLIDERS ONLY



Item description: ICOF-SLIDER-PET
Item number: AA1313631

Application type: PET



Item description: ICOF-SLIDER-CAN
Item number: AA1313632

Application type: CAN



Item description: ICOF-SLIDER-GLASS
Item number: AA1313633

Application type: GLASS



BOX INCLUDES:

- iCOF condition monitoring device
- Puck
- Slider (PET, CAN or GLASS)
- Set of screws for slider
- Screw driver
- USB drive with GUI

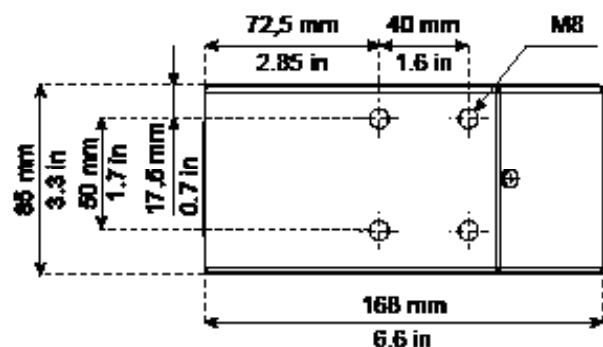
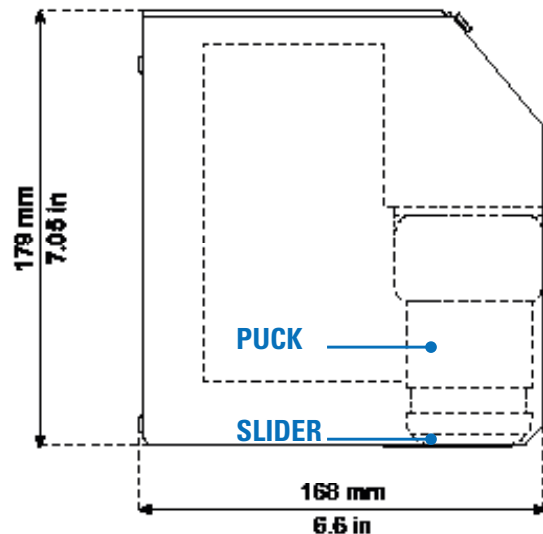

THE iCOF[®] MONITORING DEVICE?

Monitoring device helps monitor bottling or canning line by measuring the coefficient of friction, reducing operator intervention.

Resources available to monitor Continuous and automatic condition make sure that the line efficiency stays sustained high level.

ICOF® CONDITION MONITORING DEVICE ACCESSORIES

POWER SUPPLY

Item description: ICOF-KIT POWER SUPPLY

Item number: AA8314771

100-240V 24V-1.25A 50-60HZ



PORTABLE SUPPORT STRUCTURE

Item description: ICOF SUPPORT B520X1100XH1800MM

Item number: AA1418488

Mainly meant for stand alone use, for quick measures or when different measuring points are required

Easy assembly

Made of aluminum tubes (abt 20kg weighth)

Overall dimensions: 1100 x 520 x 1800 mm

Work layer: adjustable from 979 to 1226 mm

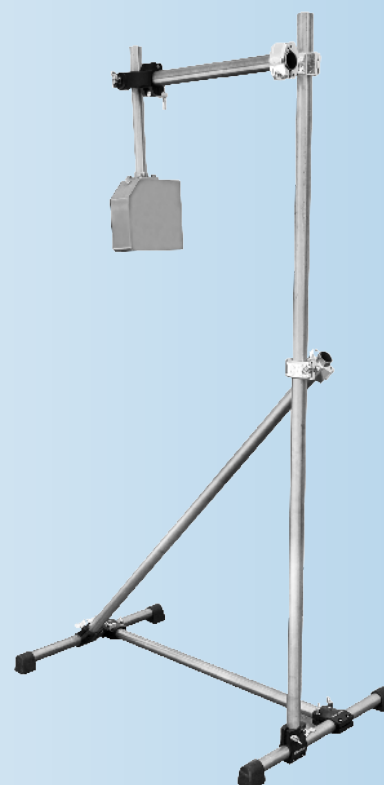

ICOF® CONDITION MONITORING DEVICE ACCESSORIES

CONTROLLER

Item description: ICOF-CONTROLLER MODULE

Item number: AA8317592

STAND ALONE: Secondary mode, for portable use and quick installation

a) CONTROLLER MODE

7 Inches touch screen, 24V industrial tablet, waterproof

Software and GUI embedded into the controller

Easy and quick connection to the iCOF device
(pre set plugs and cables)

Plug and play

Easy fixing to the conveyor frame

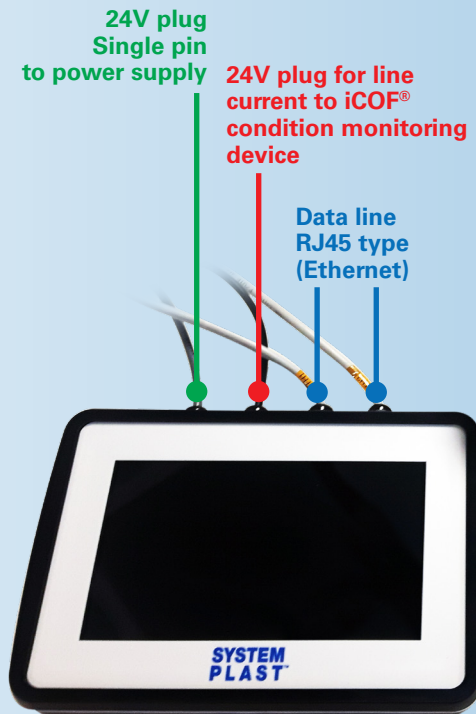
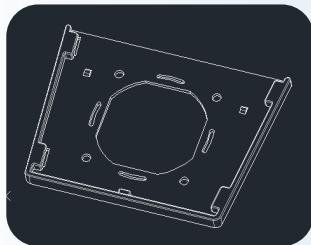

USB HARDWARE PEN

Item description: USB HARDWARE PEN

Item number: AA8314759

STAND ALONE: Secondary mode, for portable use and quick installation

b) PC MODE

Alternative mode (not recommended - PC often not allowed in line)

It requires software for data acquisition (available)

It requires PLC emulator (hardware key supplied apart)

24V adaptor to line current for iCOF condition monitoring device supplied as optional on request.

IMPORTANT NOTE

This mode of use implies PC rights at Admin level.

Being the architecture of the software is based on the PLC architecture, it may become necessary to bypass the firewall by opening some backdoors.

This often is a not acceptable condition for a PC security.





SYSTEM PLAST

Motion Control Solutions Regal Rexnord

Customer Service: 800-626-2120

Technical Service: 800-626-2093

CustomerService.PTSolutions@regalrexnord.com

regalrexnord.com

The proper selection and application of products and components, including assuring that the product is safe for its intended use, are the responsibility of the customer. To view our Application Considerations, please visit <https://www.regalrexnord.com/Application-Considerations>.

To view our Standard Terms and Conditions of Sale, please visit <https://www.regalrexnord.com/Terms-and-Conditions-of-Sale> (which may redirect to other website locations based on product family).

"Regal Rexnord" is not indicative of legal entity. Refer to product purchase documentation for the applicable legal entity. Regal Rexnord, iCOF and System Plast are trademarks of Regal Rexnord Corporation or one of its affiliated companies. © 2018, 2022 Regal Rexnord Corporation, All Rights Reserved. MCB22134E • Form# 10247E

 **RegalRexnord**[™]